

Bespoke Single Door / Bespoke Frameless Hinged Door + Inline Panel

Instruction Manual

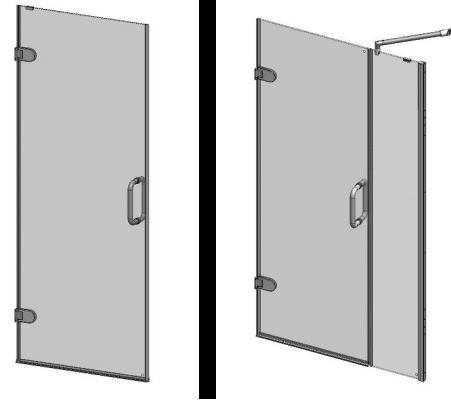

Truelife Consumer Guarantee

Please make sure the purchaser/end user completes and returns the Guarantee card which is enclosed with this product or registers on line at www.roman-showers.com/register_guarantee.htm. Failure to validate the Roman Truelife Guarantee will mean only the 1 Year Statutory Guarantee will apply.

IMPORTANT

- Please ensure the consumer guarantee card enclosed with this product is completed and returned to Roman; please ensure the end user retains this manual.
- Please read all instructions carefully before attempting installation.
- Handle the product with care to avoid damage to the product finish.
- Check for hidden electrical cables and water pipes prior to commencing any drilling work.
- Images are used for illustration purposes only, product designs may differ slightly as a result of continuing product development.
- Roman Sculptures enclosures are heavy, this enclosure installation must be carried out by a minimum of two people to avoid possible lifting injury and damage to the large glass panels.
- Roman's toughened glass is completely safe for use in our shower enclosures and bath screens; providing our products are installed according to our guidelines.
- It is important to note, that the glass must not be mounted or 'pinched' in such a way that would cause a stress point to develop in the glass. In addition, it must not be subjected to any sharp impact or severe temperature fluctuation which may also cause a stress point to develop in the glass.
- Roman's toughened glass is physically and thermally significantly stronger than standard glass. During our toughening process the stresses contained within any glass are balanced so if in the unlikely situation any of the above occurs and the glass breaks, the glass will shatter safely into small thumbnail sized blunt fragments.

Component Check List: Supplied (Single Door)

Description	Quantity
Door Glass	1
Hinges	2
Handle	1
Branding Clip	1
Bottom Rail	1
Vertical Bubble Seal	1
Bottom Seal	1
Spacers	2

Component Check List: Supplied (Door + Inline Panel)

Description	Quantity
Door Glass	1
Panel Glass	1
Wall Profile Assembly	1
Hinges	2
Handle	1
Bracing Assembly	1
Branding Clip	1
Bottom Rail	1
Vertical Bubble Seal	1
Bottom Seal	1
Spacers	2

Installation Site Preparation - Site Preparation

Walls

The walls to which the enclosure is to be fitted to must be vertical with no more than 5mm deviation. A maximum of 5mm adjustment is provided within the enclosure to take account for untrue walls.

Tray

If fitting to a tray the following requirements must be met before installation can commence:

- The tray must be a Roman product.
- The tray must be fitted according to the Roman instruction manual supplied with the tray.
- Any tiling of the walls **must not** overhang the tray by more than 5mm. The tray can be offset from the wall to achieve this, see image below.
- Any tiling and sealing around the tray and enclosure area must be completed and fully dry.

Wetroom Installation

For wet room Installation an F20 glass / floor protector is recommended. Please contact customer services on 01325 328034 to request your pack.

Equipment Check List: Not Supplied

Description

- PZ2 Pozidrive Screwdriver
- Bathroom Sealant Gun
- Spirit level (large)
- Drill and 6mm Masonry Bit
- Tape Measure
- Pencil
- Allen Keys (supplied)
- Torque Wrench

N.B. Torque Wrench must be used to tighten the Allen bolts to 10N/m on the door hinges, as indicated in the door installation instructions.

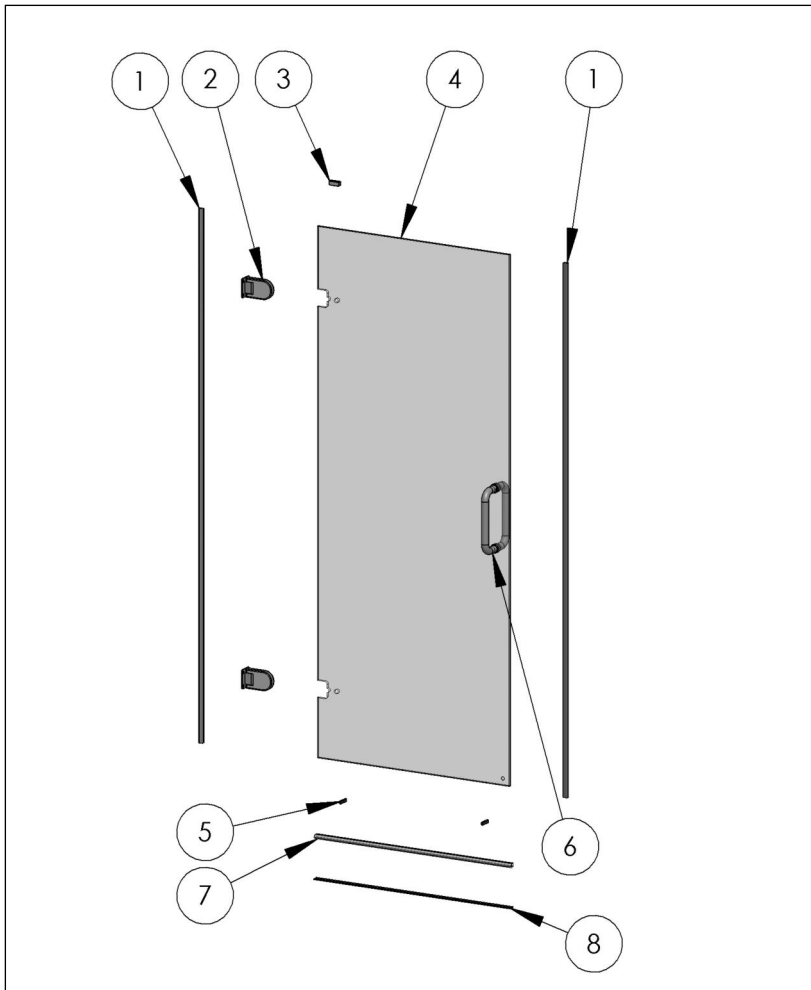

Single Door Parts List		
ITEM NO.	DESCRIPTION	QUANTITY
1	Vertical Bubble Seal	2
2	Hinges	2
3	Branding Clip	1
4	Door Glass	1
5	Spacers	2
6	Handle	1
7	Bottom Seal	1
8	Bottom Rail	1

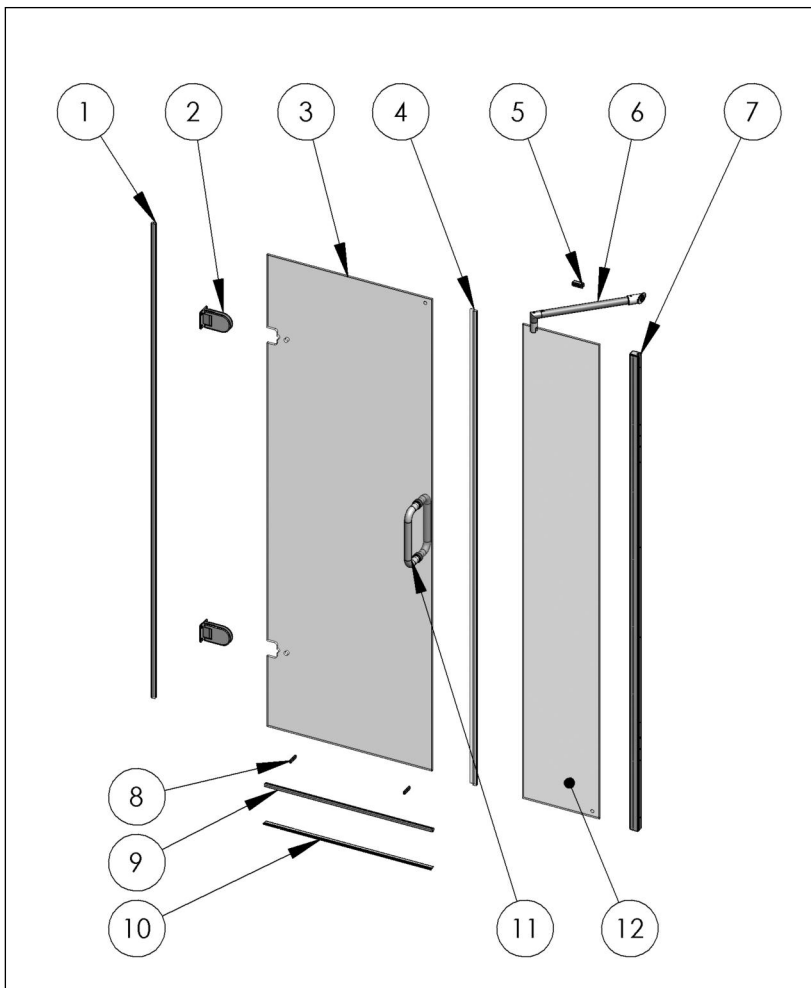

Door and Inline Panel Parts List		
ITEM NO.	DESCRIPTION	QUANTITY
1	Vertical Bubble Seal	1
2	Hinges	2
3	Door Glass	1
4	Panel Seal	1
5	Branding Clip	1
6	Bracing Assembly	1
7	Wall Profile Assembly	1
8	Spacers	2
9	Bottom Seal	1
10	Bottom Rail	1
11	Handle	1
12	Panel Glass	1

Step 1 - Door Fitting

⑥

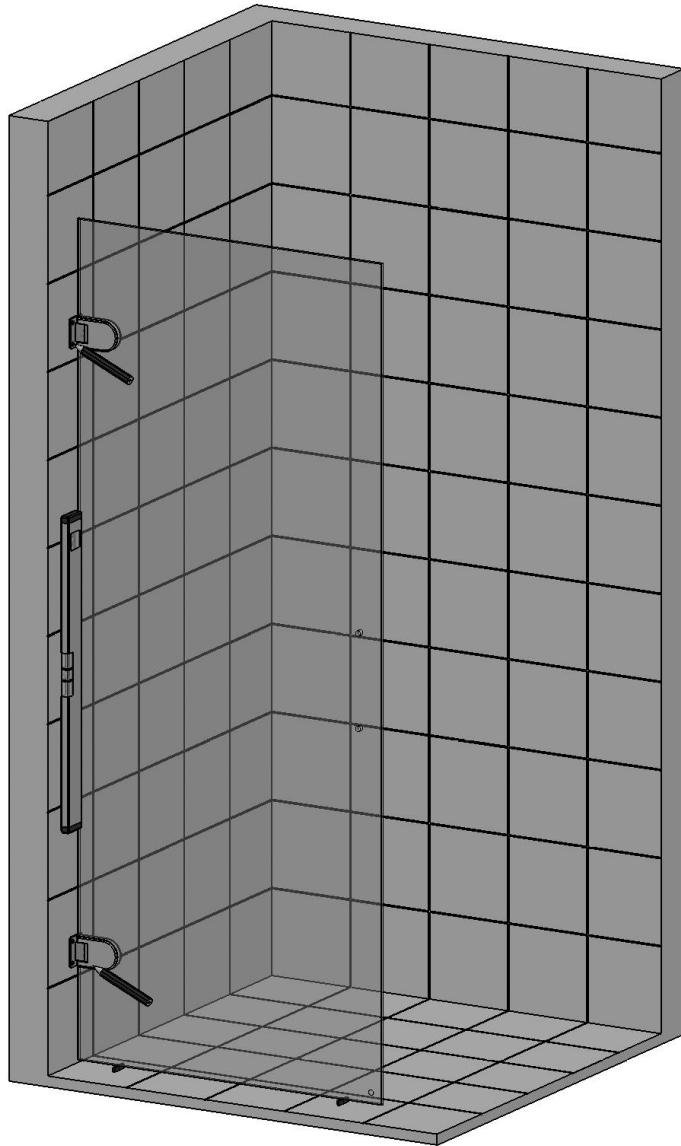

Alcove wall removed for clarity

②

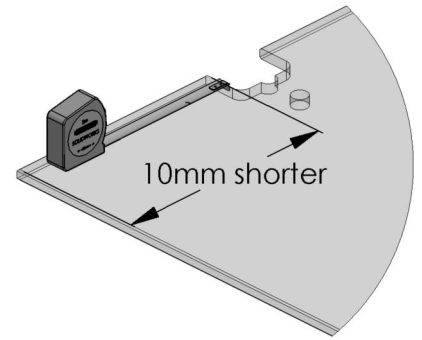

③

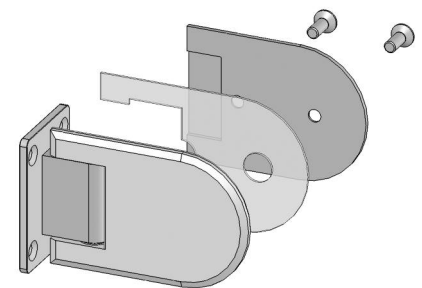

⑤

⑦



1. Place the Door Glass onto a flat - scratch free surface.
2. Determine which end of the glass is the bottom; this can be done by measuring from the edge of the glass to the start of the cut-out (the bottom is 10mm shorter than the top).
 - **Decide which side the door is to be fitted as this has an impact on the hinge fitting.**
3. Take the hinges and undo the screws from the back plates, remove the back plates and one of the gaskets.
4. Place the hinges into the cut-outs and replace the gasket and back plates, replace the screws and hand tighten.
 - **Make sure that the glass is the right way up, the hinges are on correctly (back plate to the inside) and they have gaskets on both sides of the glass.**
5. Offer the door into position and place the 2 spacers between the bottom of the glass and the floor, make sure the spacers are the correct way up i.e. 10mm gap between glass and floor.
 - **We recommend that 2 persons carry out this procedure.**
6. Use a spirit level to ensure the door is completely vertical.
7. With the door vertical and the spacers correctly placed mark all the screw positions through the holes in the hinges.
 - **We recommend that 2 persons carry out this procedure.**

Step 1 - Door Fitting - Continued

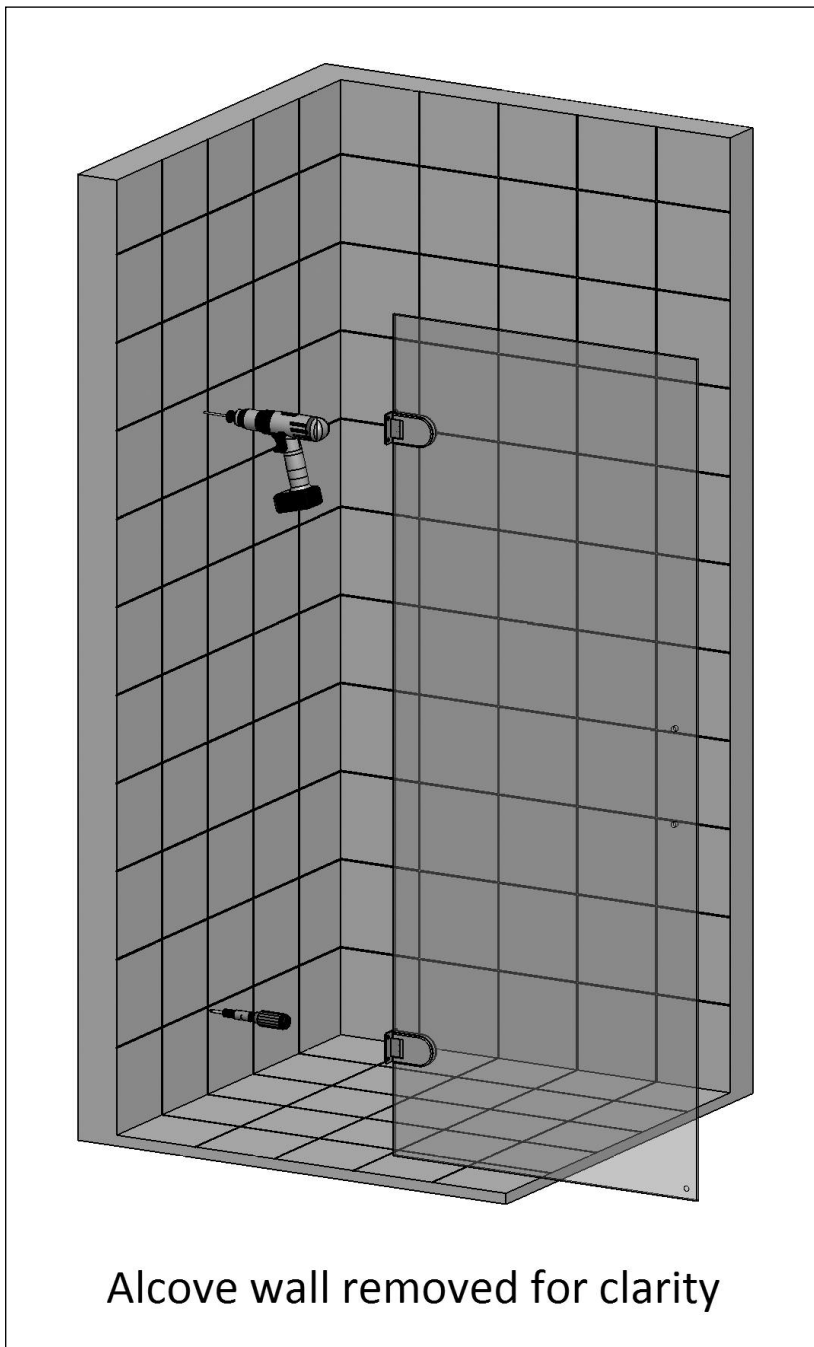

Alcove wall removed for clarity

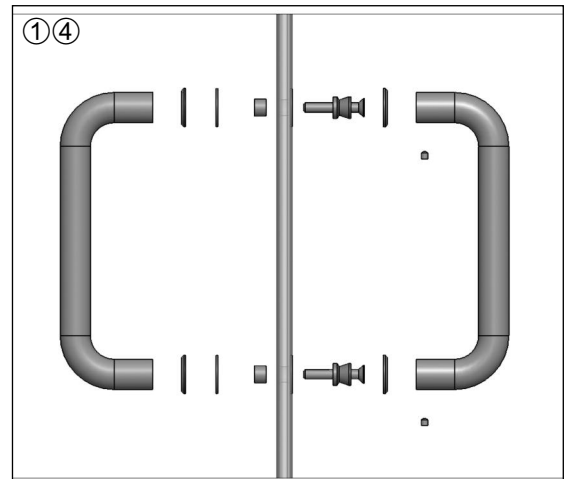

8. Move the door to a safe place and drill the holes using a 6mm masonry drill bit (not supplied).
9. Push the wall plugs (supplied) into the drilled holes.
10. Place the Door Glass with the hinges back onto the spacers and reposition to the wall.
 - **We recommend that 2 persons carry out this procedure.**
11. Ensure the Door Glass is vertical and fasten to the wall using the screws supplied with the hinges.
 - **You may need to operate the door to enable this.**
12. Now tighten the allen screws on the hinge back plates to 10Nm with a torque wrench.
13. Once secured to the wall and the back plates fully tightened remove the 2 spacers from between the glass and floor.
14. Remove the handle from the packaging, using the allen key loosen the grub screws and dismantle, re-assemble onto the door as shown.
 - **Please ensure that the side with the grub screws faces in towards the showering area.**
15. For fitting the inline panel move to step 4.

Step 2 - Bottom Rail and Seal Fitting - Single Door Only

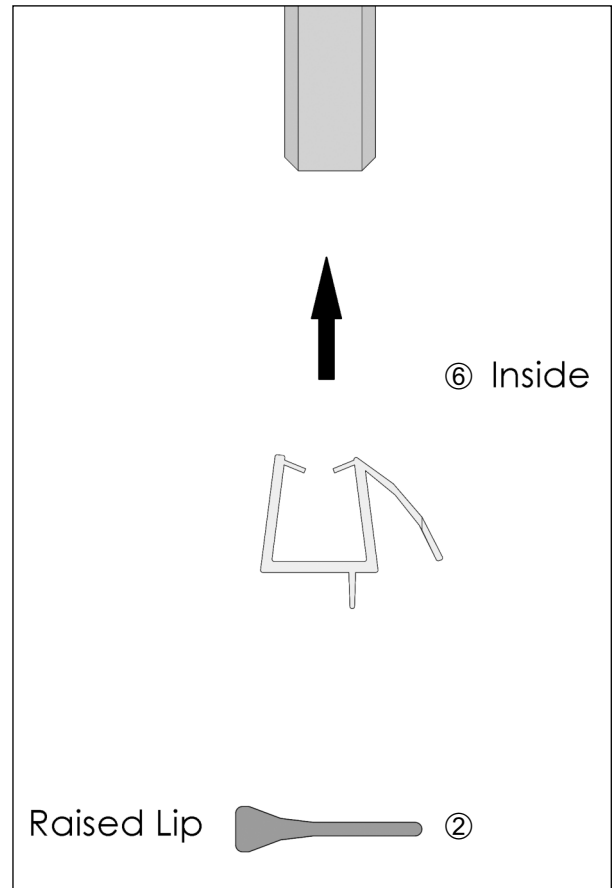
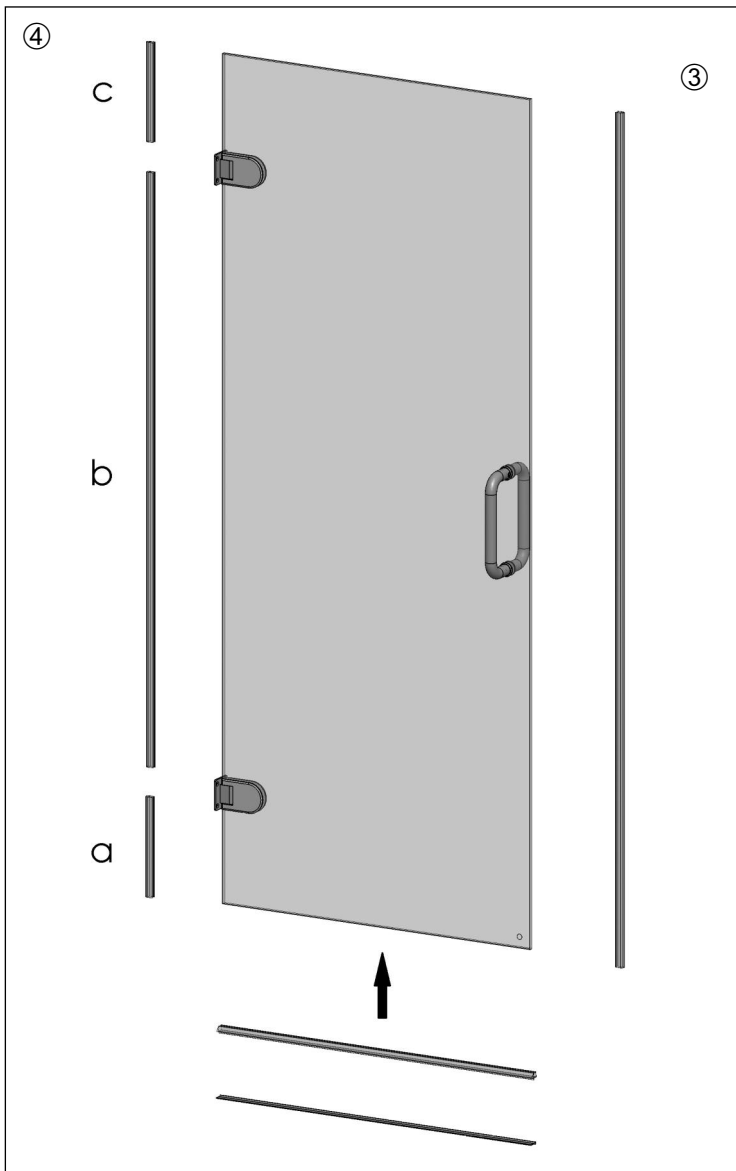

1. Measure accurately between the walls, using this measurement cut the bottom rail to length using a hacksaw.
2. Place a bead of silicon down the full length of the bottom rail. Place the bottom rail between the walls and centrally below the Glass Door, once in place push fully down to help adhesion. Secure in place with a low adhesive tape and secure to the floor and leave for 2 hours minimum. The tape should be placed at both ends and one in the centre of the bottom rail.
 - **Ensure the raised lip is facing towards the outside of the showering area, failure to do so may result in the enclosure leaking and will not be covered under the terms of the guarantee.**
3. Fit one of the vertical bubble seals to the handle side of the door so that it sits on top of the bottom rail.
4. The bubble seal for the hinge side will need to be cut down into 3 pieces so that it fits (a) between the top of the bottom rail to the underside of the bottom hinge, (b) between the hinges and (c) from the top of the upper hinge to the top of the Door Glass.
 - **IMPORTANT – All seals must be cut square and to the correct length using a Stanley knife or similar, please take care when cutting.**
5. Make certain the vertical bubble seals touch the walls; the seals can be brought off the glass to achieve this.
6. Accurately measure between the vertical bubble seals, using this measurement cut the bottom seal to length.
 - **Ensure the angled deflector faces in towards the showering area, failure to do so may result in the enclosure leaking and will not be covered under the terms of the guarantee.**

Step 3 - Aligning the Door if required

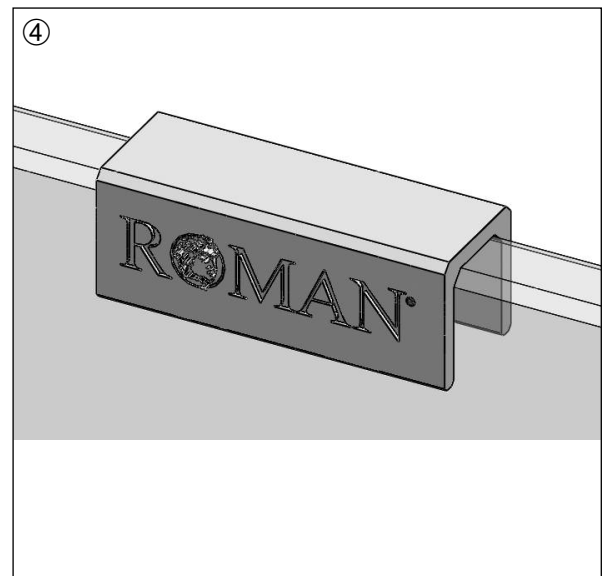
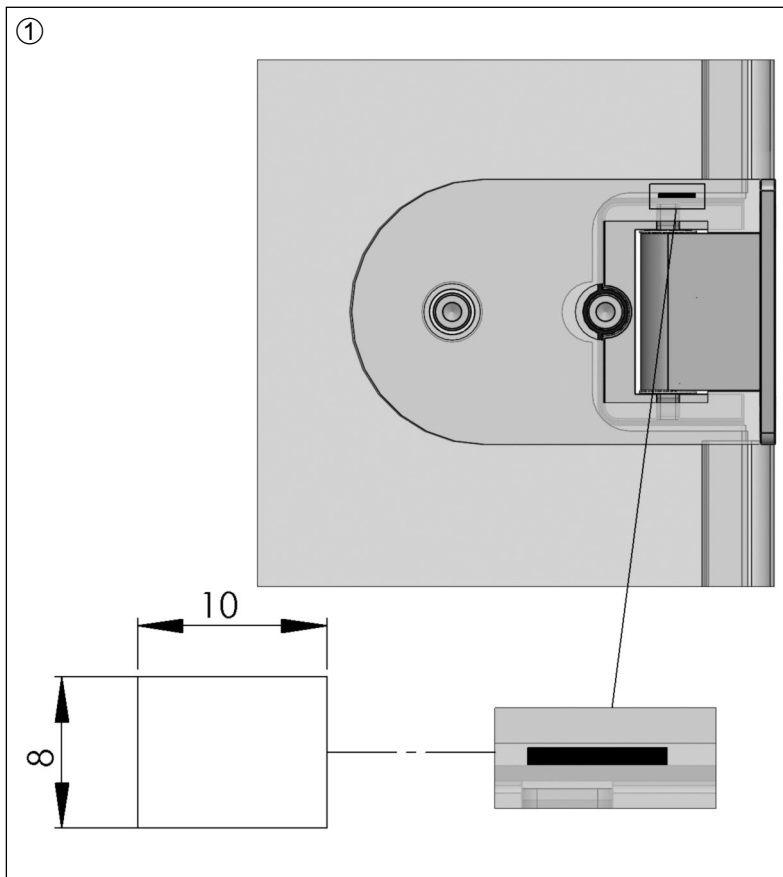

1. Once the door is fitted it may need to be realigned, loosen the allen screws on both of the hinges and remove the back plates, gently ease the door into the new position – it may however be necessary that 10 x 8 plastic spacers are placed between the hinge and the glass as shown above.
 - **We recommend that 2 persons carry out this procedure.**
2. Re-assemble the back plates and tighten the allen screws to 10Nm with a torque wrench.
3. Check that all the seals are correctly fitted and adjust as necessary.
4. When all the assembly steps have been completed and all the screws tightened fit the Roman Branding Clip to the top of the glass and fix in place with a small amount of sealant.

Step 4 - Panel Wall Profile

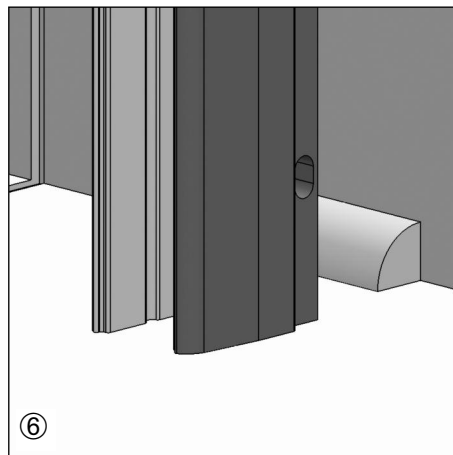
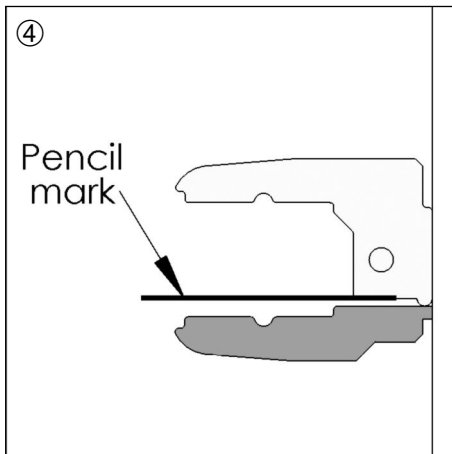
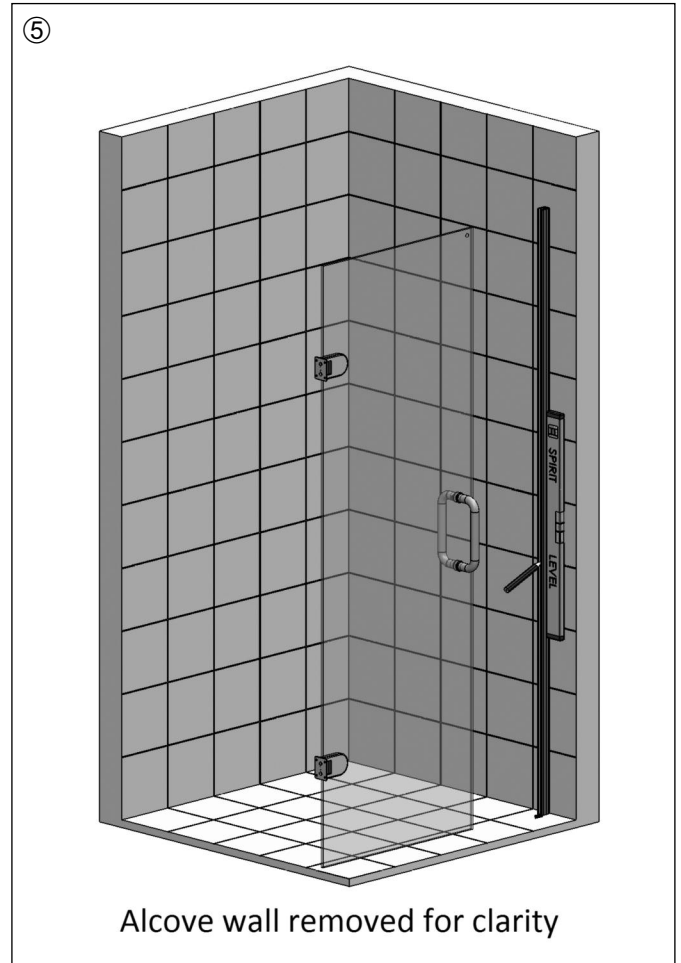
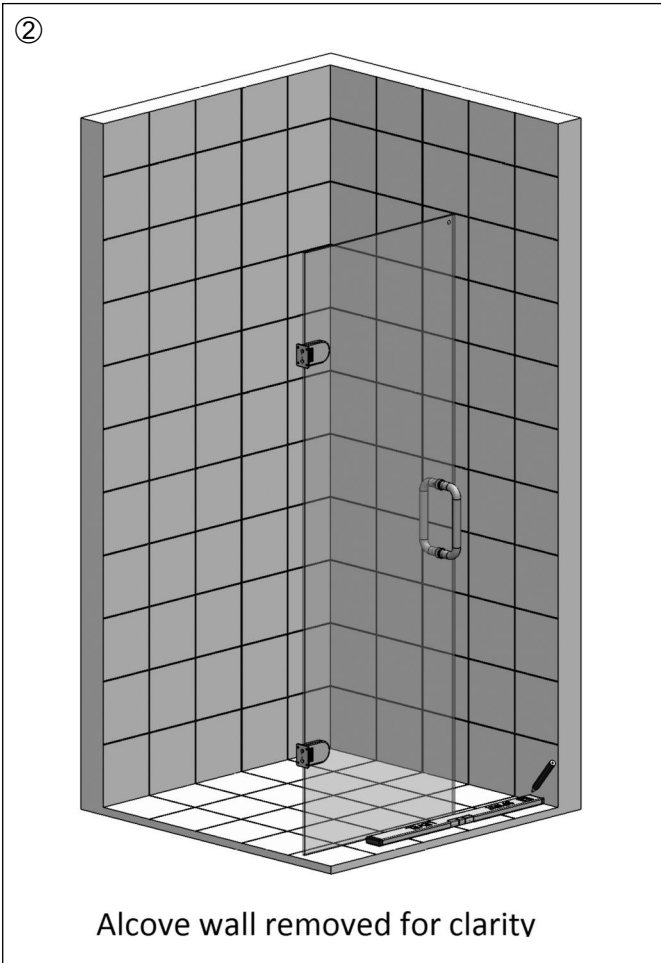

1. Place the door in the closed position.
2. Using a spirit level or a similar straight edge place this so that it is in line with the outside of the door, using a pencil mark the floor at the corner.
3. Remove the flexible seal from the Wall Profile assembly and keep in a safe place
4. Place the Wall Profile assembly on the pencil mark you have just created.
5. With a spirit level make the assembly vertical (keeping it on the line) mark the wall through the holes.
6. Drill the holes using a 6mm masonry drill (not supplied) and push the wall plugs (supplied) into the drilled holes. Apply a bead of silicon the width of the wall profile at the bottom where it meets the tiled wall.

- **IMPORTANT - Failure to carry out this procedure can result in serious water damage and is not covered under the terms of the guarantee.**

7. Screw fix the Wall Profile assembly to the wall using the 40mm screws supplied.

Step 5 - Fitting Panel

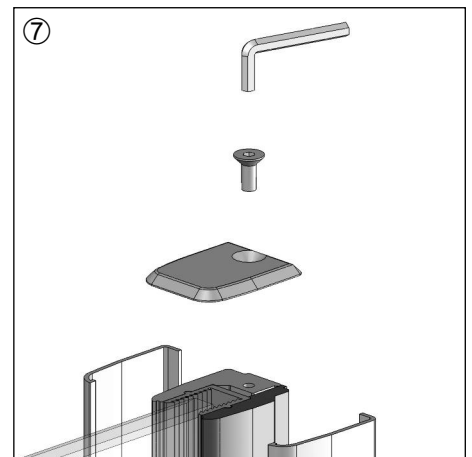
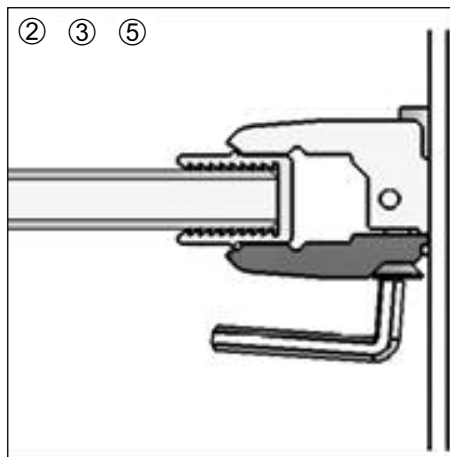
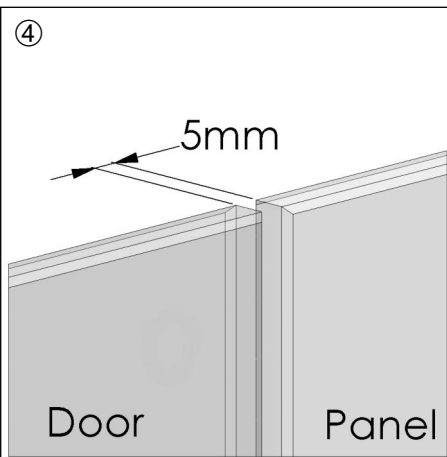
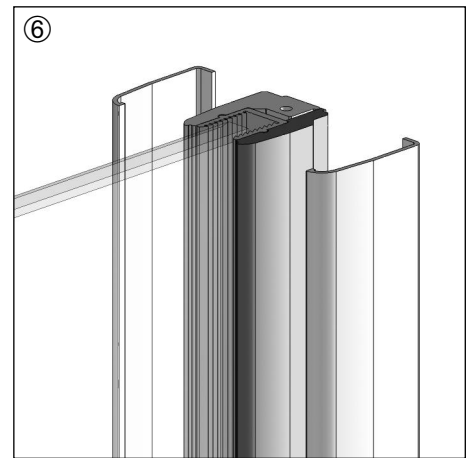
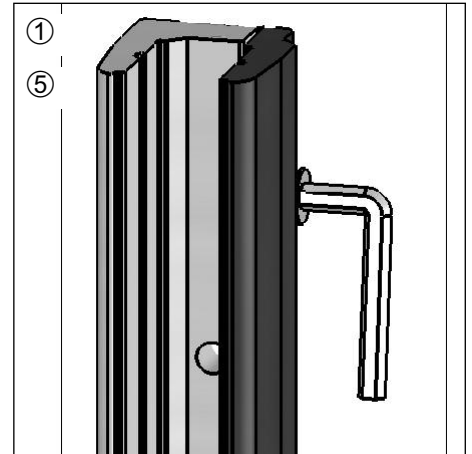
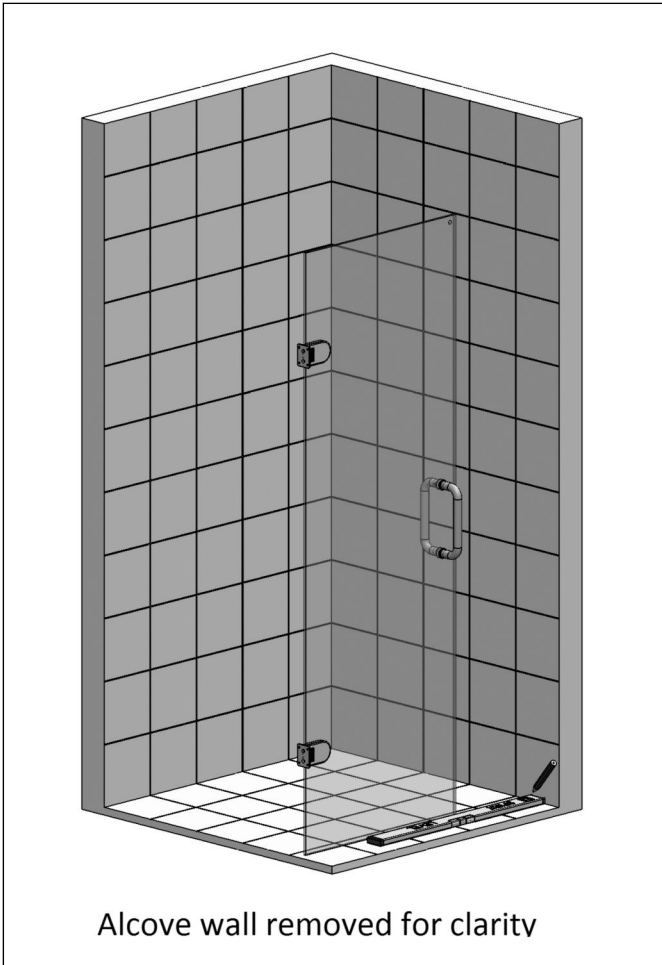

1. Using an allen key (Supplied) loosen the screws down the side of the Wall Profile assembly.
2. Take the flexible seal and place onto one end of the Panel Glass.
3. Push the end of Panel Glass with the flexible seal on into the Wall Profile assembly.
4. Position until a gap of 5mm is achieved between the Panel Glass and Door Glass.

- **The Panel Glass must be completely vertical and horizontally level prior to tightening the screws (the bubble must be in the centre of the two lines on the spirit level).**

5. When in the correct position fully tighten the wall profile screws with the allen key (supplied).
6. Clip on the cover plates from the Wall Profile assembly onto both sides of the wall profiles.
7. Screw fix the top cap to the Wall Profile assembly.

Step 6 - Bracing

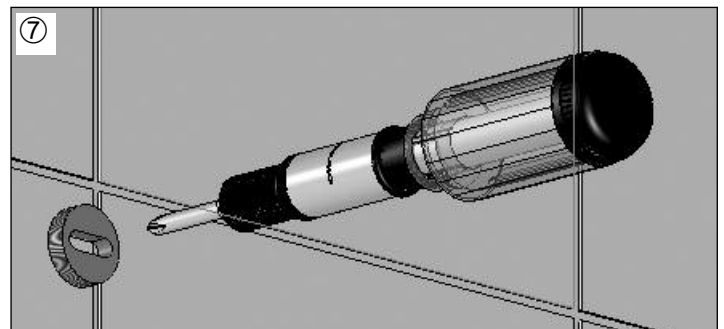
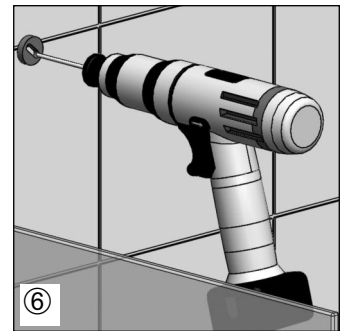
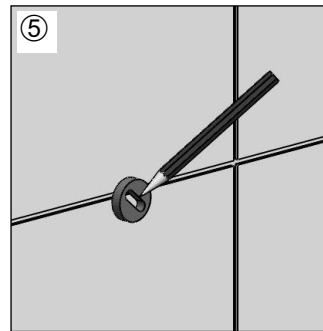
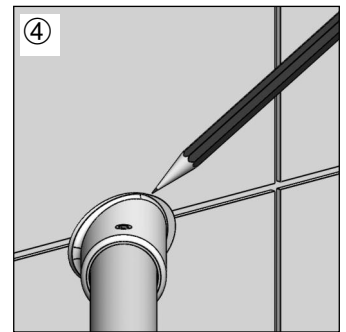
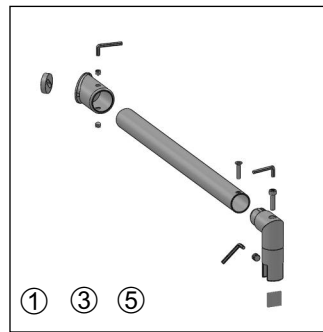
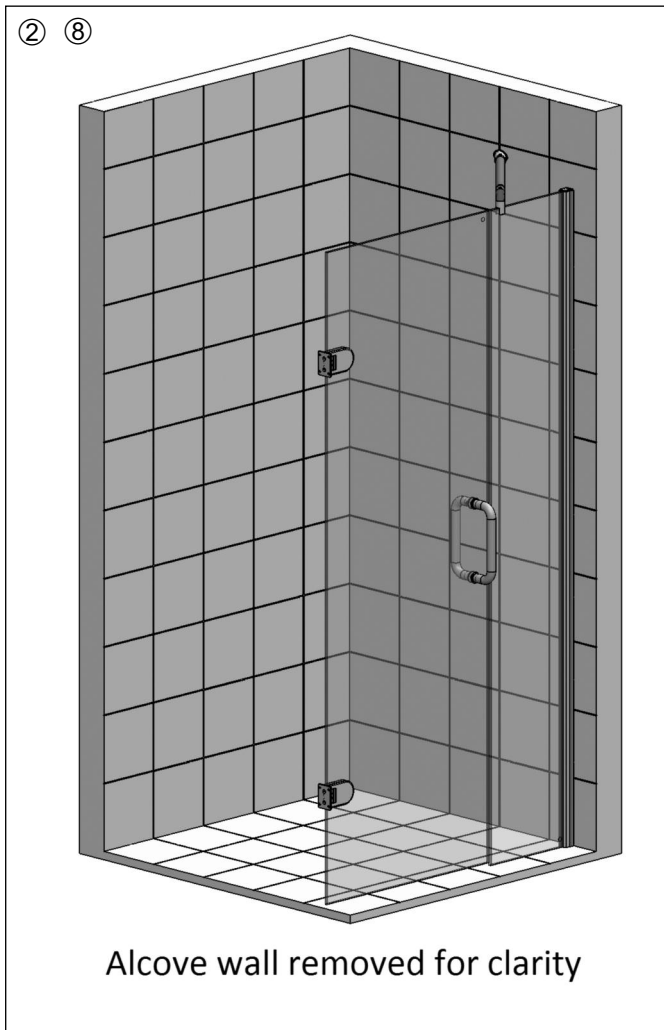

1. Assemble the straight section of the brace bar onto the Low Level Brace assembly and fasten together with the countersunk screw, then slide the wall cup onto the other end of the brace bar.
2. Position the bracing onto the panel; depending on the panel width this may not be possible so a judgement call by the installer on the brace bar length is required.
 - **The panel is bespoke and the brace bar length is 1000mm as standard.**
 - **IMPORTANT – Only cut down at the wall cup end.**
3. Slightly loosen the allen screw in the low level bracing assembly so that it can be turned to achieve the correct angle.
 - **No metal should touch the glass, the spacers must be used.**
4. Slide the whole assembly up to the tiled wall to determine the position of the wall cup, mark around the cup using a pencil.
5. Unscrew the brass insert from the end of the wall cup and position it in the centre of the pencil mark that you have just done. Mark through the slot for the position of the screw hole that is to be drilled.
6. Drill the location hole for the wall cup using a 6mm masonry drill (not supplied) and insert the wall plug.
7. Fix the brass insert to the wall using the 40mm screws (supplied) and then screw the wall cup onto the brass insert so that it is tight up to the tiled walls.
8. Assemble the bracing bar back onto the panel and into the wall cup
 - **No metal should touch the glass, the spacers must be used.**
9. When you are satisfied that the brace bar has been positioned correctly, tighten all the screws on the wall cup and on the low level brace assembly with an allen key.
 - **There is 18mm of adjustment in the brace bar to allow for correct alignment.**

Step 7 - Bottom Rail and Seal Fitting - Inline Panel Only

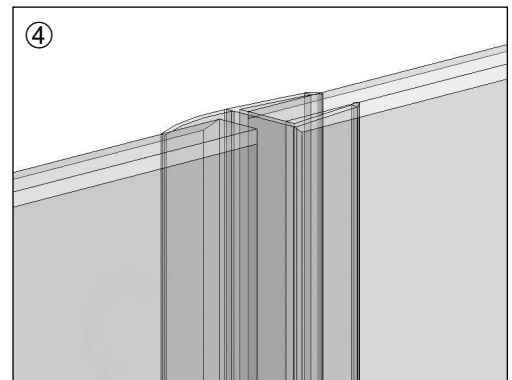
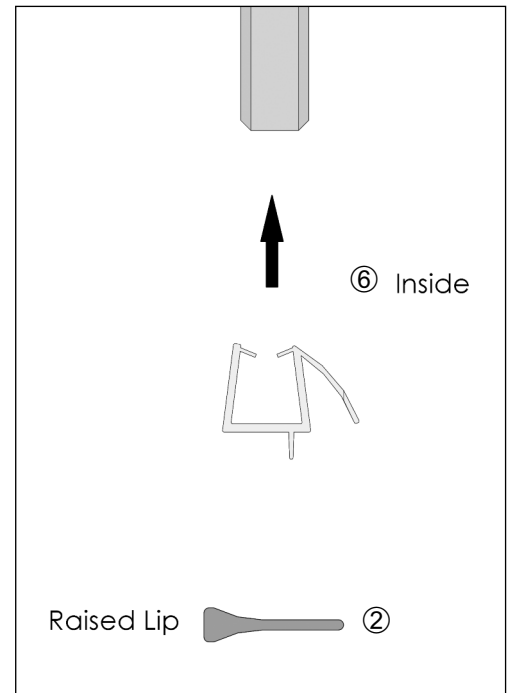
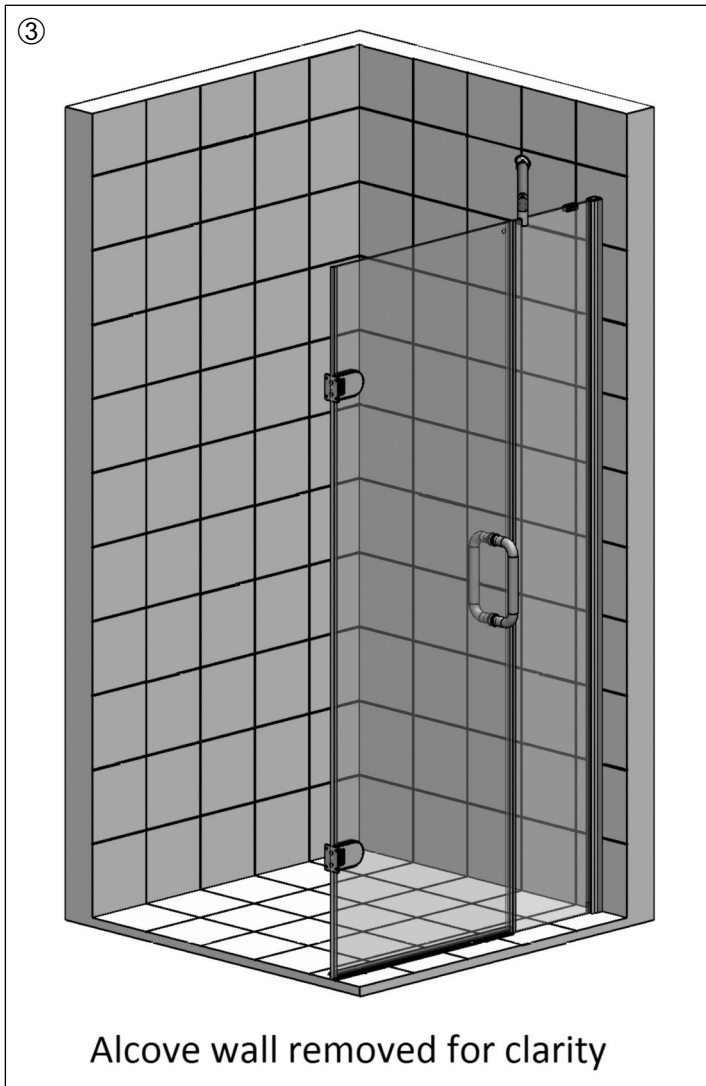

1. Measure accurately between the wall at the hinge side and the end of the panel, using this measurement cut the bottom rail to length using a hacksaw.
2. Place a bead of silicon down the full length of the bottom rail. Place the bottom rail between the wall and panel centrally below the Glass Door, once in place push fully down to help adhesion. Secure in place with a low adhesive tape and secure to the floor and leave for 2 hours minimum. The tape should be placed at both ends and one in the centre of the bottom rail.
 - **Ensure the raised lip is facing towards the outside of the showering area, failure to do so may result in the enclosure leaking and will not be covered under the terms of the guarantee.**
3. The bubble seal for the hinge side will need to be cut down into 3 pieces so that it fits (a) between the top of the bottom rail to the underside of the bottom hinge, (b) between the hinges and (c) from the top of the upper hinge to the top of the Door Glass, see Step 2, line 4.
 - **IMPORTANT – All seals must be cut square and to the correct length using a Stanley knife or similar, please take care when cutting.**
4. Fit the panel seal to the edge of the panel with the flipper being on the inside.
5. Make certain the vertical bubble seals touch the wall; the seal can be brought off the glass to achieve this.
6. Accurately measure between the vertical bubble seal and the panel seal, using this measurement cut the bottom seal to length.
 - **Ensure the angled deflector faces in towards the showering area, failure to do so may result in the enclosure leaking and will not be covered under the terms of the guarantee.**

Step 8 - Sealing

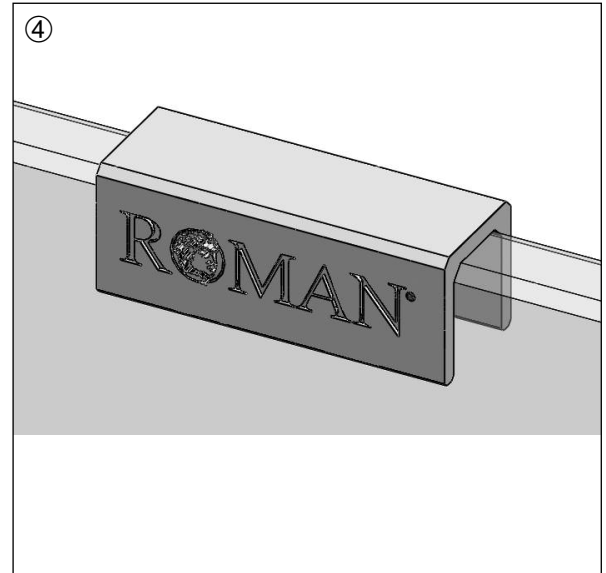
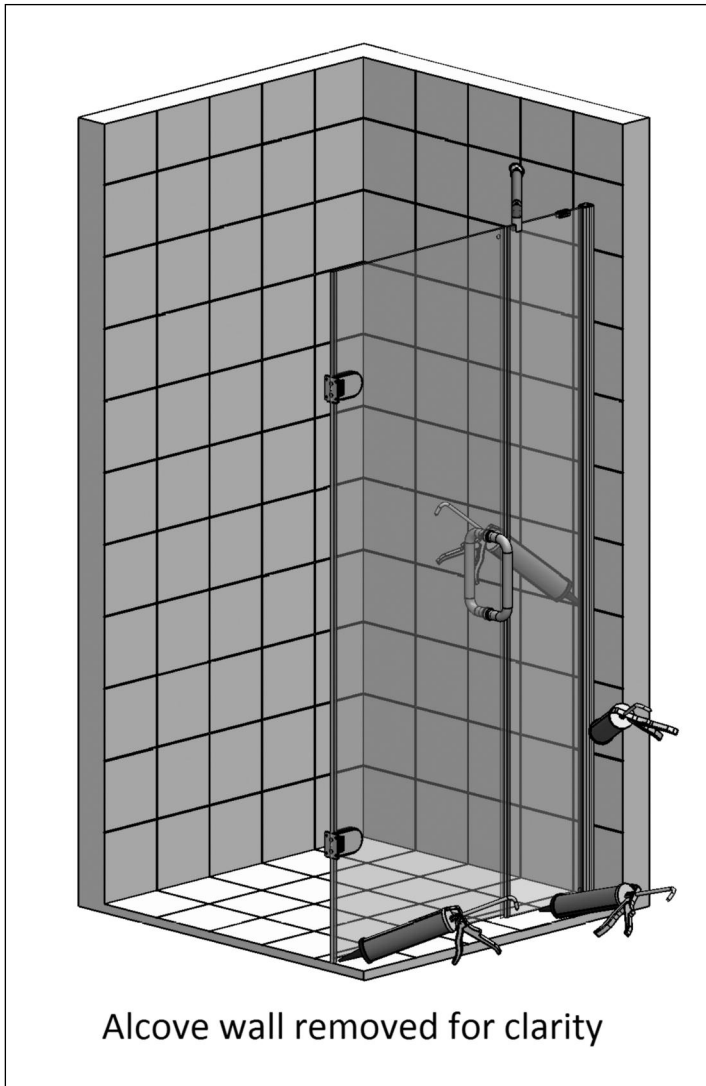

1. Fully seal the base of the panel on the outside only.
 2. Apply a thin bead of silicon between the ends of the bottom rail to the Panel Glass and wall.
 3. Seal both sides of the wall profiles inside and outside vertically where they meet the tiled wall.
- **Very important: Failure to follow the procedure in lines 1 - 2 may result in serious water damage and is not covered under the terms of the guarantee.**
4. When all the sealing has been completed fit the Roman Branding Clip to the top of the Panel glass and fix in place with a small amount of sealant.

Should you experience any problems during installation please refer to the Trouble Shooting Guide on back page or contact Roman Customer Services on: 01325 328034.

To enable Customer Services to provide you with an excellent level of service it is important that you quote your Product Code and Reference Number - these numbers can be found on the front of your Instruction Manual

Maintaining Your Enclosure

DO NOT use acidic based descaler products or products which are unsuitable for cleaning enamel surfaces, including abrasive cleaners or cleaners containing bleach or solvents, as these products will affect both the anodised and coated framework.

NEVER use scouring powder or pads or sharp instruments when cleaning the enclosure.

Roman Shower Enclosures and Bath Screens are designed for luxury showering and with care and attention you can keep them looking new for longer by using the strongly recommended **Roman Ultra Care** (see back page), the multi-purpose glass protector after cleaning. Alternatively, occasionally wipe your Roman Shower Enclosure with a mild detergent diluted with water and polish with a soft cloth. If you live in a hard water area, periodically clean with a 50/50 solution of white vinegar and soak for five minutes and remove any limescale residue by rinsing with warm water. Periodically clean the seals of your Enclosure with an anti-bacterial spray. This is all you require to keep the glass, seals and coated / anodised aluminium parts looking new.

SCULPTURES TROUBLE SHOOTING GUIDE.

Problem

Solution

LEAKING

1. Check there is a bead of bathroom sealant the width of the wall profiles has been placed between the tiled wall and tray top where the wall profile meets the tiled wall: Step 4, line 6.
2. Check that the base of the enclosure is sealed to the tiled floor from the outside only: Step 8, line 1.
3. Check to see if the wall profiles have been sealed vertically inside and outside where they meet the tiled wall only: Step 8, line 3.
4. Check that the bottom rail is sealed between the Panel Glass and wall: Step 8, line 2.
5. Check that the base of the Enclosure hasn't been sealed to the tray top on the inside of the cubicle
6. Check that the Vertical bubble seal / seals are touching the wall: Step 2, line 5.
7. Check the angled deflector on the bottom seal has not been flattened in transit and is on the inside: Step 2, line 6.

ENCLOSURE

ALIGNMENT ON TRAY

1. Check the enclosure is fitted to a tiled wall
2. Check that the walls fall between the adjustment sizes
3. Check that the wall profile has been fitted completely vertical (the bubble must be in the centre of the two lines on a spirit level): Step 4, line 5
4. Ensure the Enclosure is completely vertical and level (the bubble must be in the centre of the two lines on a spirit level)

DOOR OPERATING CORRECTLY

1. Check that the wall profile and the glass panel are completely vertical (the bubble must be in the centre of the two lines on spirit level)
2. Check that the door is hanging vertical and horizontal.

DOOR ALIGNMENT

1. Ensure the tiled floor is level and the walls fall between the adjustment sizes
2. Ensure the wall profile(s) are vertical (the bubble must be in the centre of the two lines on a spirit level).
3. Ensure the Enclosure is completely vertical and level (the bubble must be in the centre of the two lines on a spirit level)

Important

The walls which the enclosure is to be fitted to must be vertical with no more than 5mm deviation. A maximum of 5mm adjustment is provided within the enclosure to take account for untrue walls.

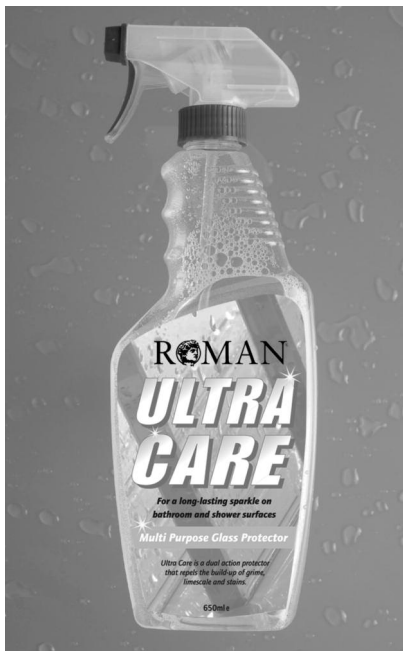

Ultra Care

THE MORE YOU SPRAY – THE MORE YOU PROTECT.

Roman Ultra Care is a product from Roman designed to give all your shower and bathroom surfaces a long-lasting sparkle. The benefit of Ultra Care is the more you spray, the more you protect.

Ultra Care is a multi-purpose glass protector that repels the build-up of grime, limescale and stains.

Roman Ultra Care was developed for Roman shower enclosures and screens. It is a unique and effective non-filming formula for all glass surfaces, tiles, shower seals and aluminium frames, taps, trays and baths.

Why not try it on your car windscreen!

For your nearest stockist please call +44 (0) 1325 328034

ROMAN LIMITED, WHITWORTH AVENUE, AYCLIFFE INDUSTRIAL PARK, COUNTY DURHAM, DL5 6YN, ENGLAND, UK.

Member of



GENERAL RECEPTION: PHONE +44 (0) 1325 311318 FAX +44 (0) 1325 319889

CUSTOMER SERVICES: PHONE +44 (0) 1325 328034 FAX +44 (0) 1325 328031

SALES ENQUIRIES: PHONE +44 (0) 1325 328033 FAX +44 (0) 1325 328027

www.roman-showers.com